

In order to have a safe and comfortable riding enjoyment on your Giutex bike, please follow the pictures to operate the bike and read this manual completely before riding.

### SAFETY

- Before you ride your bike for the first time, familiarize yourself with the location and operation of all of the black nuts, quick release levers on your Giutex bicycle.
- Always check to make sure that both black nuts, all quick release levers are properly secured each time before you ride in order to make sure that the frame does not waggle.
- The two (2) black nuts under the painted frame main-tube must be well locked the frame main-tube for safety and more stability.
- Make sure that the seat post quick release is securely fastened and that the seat post does not slip before you ride.
- Never operate the bicycle if the frame, wheels or quick release levers are damaged.
- Maximum weight allowance is as follows: Giutex bicycles - max weight = 100 kgs/220 lbs
- Proper maintenance and adjustment of the Giutex bicycle will greatly increase riding safety and performance.
- Always check your tires for proper inflation that is indicated on the tire's sidewall.
- Reflectors alone are not adequate for riding at night. Front and rear lighting systems are recommended to increase visibility.
- Always wear a helmet when riding the bicycle.
- The bicycle is designed for all users. However, parental supervision is recommended when the bicycle is used by children.
- Remember to comply with all bicycling safety laws and use common sense especially in adverse weather conditions.
- Giutex takes no responsible for accidents resulting from failure to comply with all bicycling safety laws, careless driving or improper maintenance of your bicycle.

### STRETCHING/COLLAPSING FRAME INSTRUCTIONS

Before riding your bicycle for the first time, familiarize yourself with the bicycle's stretching and collapsing procedures. With a little practice, you should be able to fold up your Giutex bicycle in under 20 seconds.

### ASSEMBLY

In the event that your new Giutex bicycle is not fully assembled when you receive it, you need only install the pedals to complete assembly.

To install the pedals, follow these easy steps.

1. Determine which pedal is right and which pedal is left. The pedals are marked R and L at the base of the thread (the part that screws into to the crankshaft of the bike).
2. Screw the right ("R") pedal into the bike crankshaft on the right side of bike by turning it clockwise as you face the bike.
3. Screw the left ("L") pedal into the bike crankshaft on the left side of bike by turning it counter-clockwise as you face the bike.
4. Tighten both pedals, making sure that each pedal is installed securely. Failure to do so may result in the pedals coming off unexpectedly and could result in an accident or injury. Make sure the pedals are securely fastened each time before you ride.

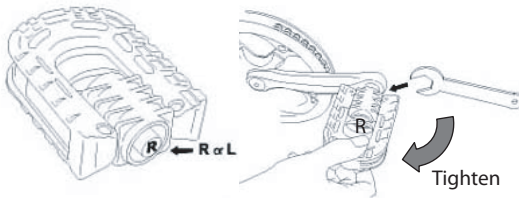

### THE FRAME OPERATION

For better operation, please stand at the left side of the bike, then,

- Screw the two black knobs under the painted frame by clockwise to lock the frame.

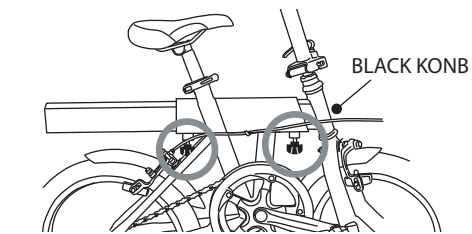

- Release the black knobs by counter clockwise to collapse the frame.
- While standing behind the seat, stretch or collapse the frame main-tube by pushing the front handlebars forward or pulling them towards you to adjust to the desired length.

- Tips for better operate the collapsing and stretching of the frame:

#### 1) Collapsing

Hold up the front brake lever by your left hand to remain still the front wheel and put your right hand on the seat post, then, it will be easier for you to slightly push the rear wheel forwarding when collapse.

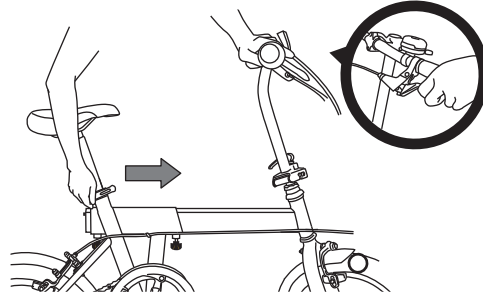

#### 2) Stretching

Put your left hand on the center of handlebar/stem, and right hand on the front end of the seat, then, slightly open up the frame to both ends.

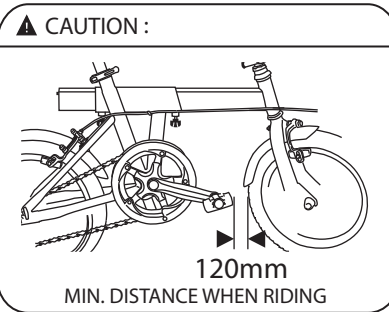
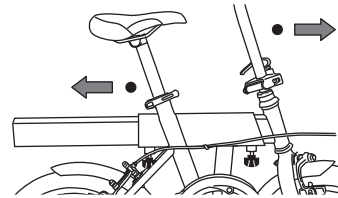

### SEAT HEIGHT AND SEAT ALIGNMENT

To raise or lower the seat post follows these steps:

1. Open the quick release lever on the vertical post of the frame by pushing it outwards.

2. Raise or lower the seat to the riders desired height. Please observe the safe limit mark.
3. Make sure the nose of the seat lines up with the centre of the handlebars.
4. Fasten the quick release lever by pushing it inward towards the seat post.

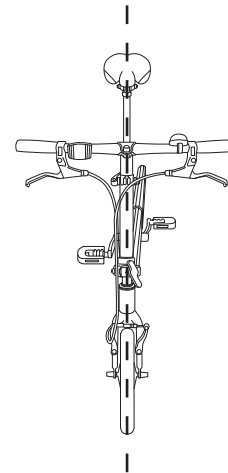

Lock bars at 90° to front wheel and Make sure the centre of the tire lines up with the centre of the handlebars.

Note: To avoid serious injury, before you ride make sure that the seat post is fastened tight enough so it doesn't slip down or swivel.

### THE PEDALS

To fold and unfold the pedals follow these steps:

1. To fold the pedals, press in the release that is located in the pedal hole (on the side that faces away from the bicycle) with your thumb or index finger.
2. Lower the pedal until it is at a 90° angle and release your thumb or index finger.
3. The pedal should click into place. If not, waggle the pedal gently until you hear the click.
4. To unfold the pedals, press in the release and raise the pedal until it is straight. The pedal should lock into place. If not, waggle the pedal gently while slowly releasing the locking mechanism until you hear the click.
5. Make sure that the pedals are securely locked into place before riding to avoid possible serious injury.

Depress pedal lock with thumb and fore finger



To fold pedals up or down

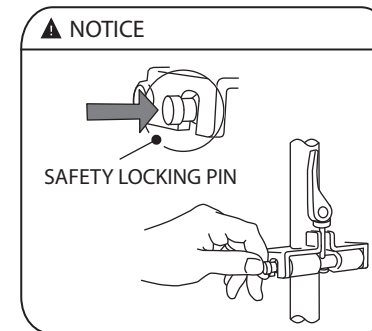
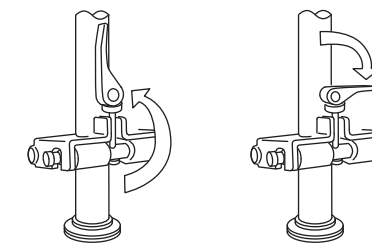

### THE FOLDING HANDLEBAR STEM

#### STYLE 1. (ONLY FOR DINO)

To collapse the folding handlebar stem follow these steps:

1. To collapse the handle bar stem, open the quick release lever on the vertical post of the handlebar stem by pushing it outwards and push in the the safety locking pin for opening.

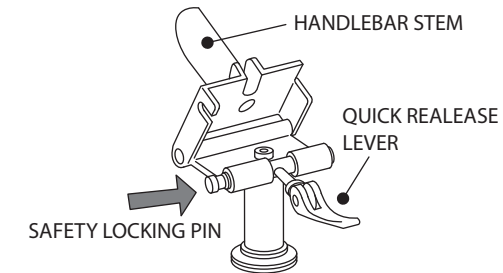

2. To raise the handlebar stem, lift it until it is completely vertical, and then pull the safety locking pin to allow the upper and bot tom parts of the folding box completely closed, then, raise the quick release lever until it locks into place. ( Note: make sure that the quick release lever is pointing down before raising it and locking it into place ).

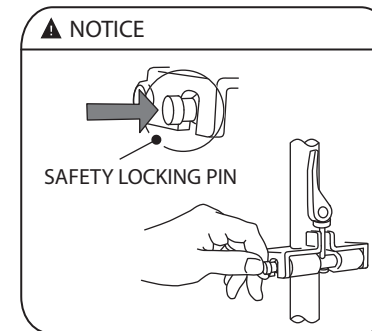
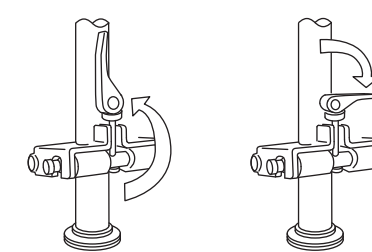

#### NOTICE

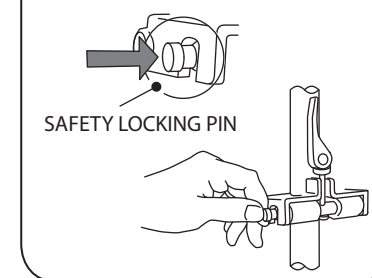

#### STYLE 2.

To collapse the folding handlebar stem follow these steps:

1. To collapse the handle bar stem, unscrew the handlebar post base clamp using the screw knob until the clamp clears the upper and lower plates.

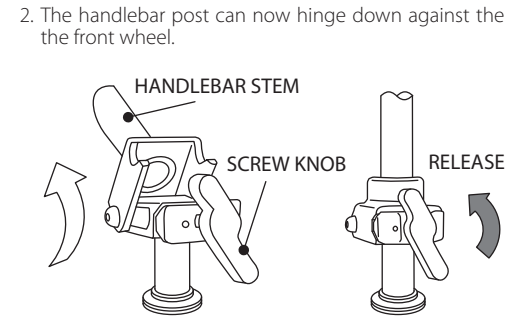

3. To raise the handlebar stem, swing the handlebar assembly up through the hinge until it stops against the lower plate.

4. Position the clamp block inside the upper and lower plates and tighten the screw knob.

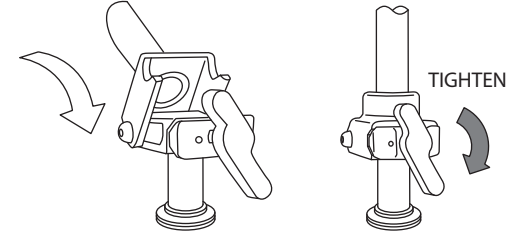

Note: To avoid possible injury, always check that the screw knob is firmly tightened before riding.

### ACCESSORIES FOR YOUR GIATEX BIKE

Giutex Stretching Bikes are designed to be sporty and functional as well as portable. Accessories are available to increase the bikes use and enhance your riding experience.

